

Installation Instructions

安裝說明書

BRAKE MASTER CYLINDER STOPPER

剎車總泵頂桿

#Q0567

Application 適用車型

HONDA CIVIC '96-00

*For LHD models 左駕車型適用

Components 內含配件

- ① Bracket A 支架A.....1pcs
- ② Bolt 螺絲 (M10x1.25x40).....2pcs
- ③ Nut 螺帽 (M10x1.25-14x9.5).....4pcs
- ④ Washer 華司 (20.8x10.7x2).....4pcs
- ⑤ Spacer 套管 (14.2x10.2x22).....2pcs
- ⑥ Bracket B 支架B.....1pcs
- ⑦ Bolt 螺絲 (M6x1.0x20).....2pcs
- ⑧ Nut 螺帽 (M6x1.0-10x6).....2pcs
- ⑨ Washer 華司 (13x6.5x1.5).....4pcs
- ⑩ Rubber 橡皮墊塊.....1pcs

Caution 注意事項

- Installation is recommended to be performed by licensed mechanics with necessary tools to ensure safety. Incorrect installation may cause injury, damage to the product or vehicle. 安裝建議由合格的技師及工具執行以確保安全。安裝錯誤可能對人員、產品及車輛造成傷害。
- Note the routing of wires and cables before installation, or please refer to factory manual. 安裝前請事先記下線路的安裝路徑及位置以維持原廠配置。有疑問時請參考原廠手冊。
- Tighten bolts and nuts firmly by using handtools, and with specified torque if mentioned. 安裝過程請使用手動工具確實鎖緊螺帽及螺絲。如有特別註明請依照說明指示的扭力上鎖。

Instructions 安裝說明

1. Install Bracket A to the driver side strut tower using supplied M10 bolts, nuts, washers and spacers.

使用附件的M10螺絲、螺帽、華司及套管，將支架A安裝至駕駛座側避震塔。

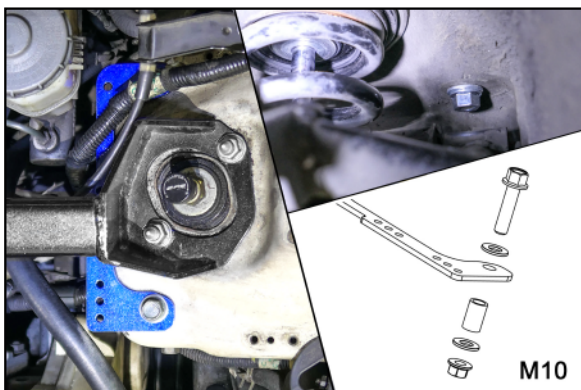

2. Install the rubber part to bracket B using supplied M10 nuts.

使用M10螺帽，將橡皮墊塊安裝至支架B。

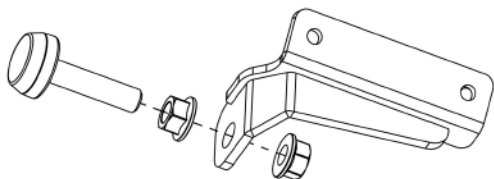

3. Install bracket B to A using supplied M6 bolts, nuts and washers. 3 settings to accommodate different master cylinders.

使用配件M6螺絲、螺帽及華司，將支架B組裝至A。可依照不同煞車總泵配置安裝至適合孔位。

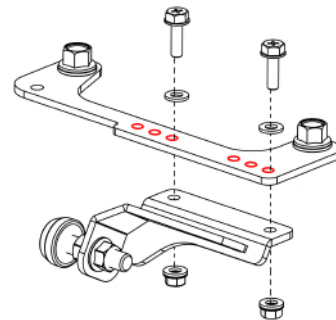

4. Adjust the rubber part until it contacts the master cylinder.

調整螺帽，使橡皮部分支撐於剎車總泵。



Illustration of installed state 安裝完成示意圖