

# Installation Instructions

## 安裝說明書

REAR ADD-ON SWAY BAR  
後加裝型防傾桿, 17mm  
#Q0497

### Application 適用車型

FORD FOCUS MK4

\*W/TORSION BEAM REAR SUSPENSION

\*適用扭力樑後懸吊車型

### Components 內含配件

- ① Sway bar 防傾桿桿身 .....1pcs
- ② Bracket-RH 支架-右 .....1pcs
- ③ Bracket-LH 支架-左 .....1pcs
- ④ Bolt 螺絲 (M10x1.5x25) .....6pcs
- ⑤ Nut 螺帽 (M10x1.5-17x10) .....6pcs
- ⑥ Washer 華司 (26x10.5x2) .....12pcs
- ⑦ Bolt 螺絲 (M10x1.25x25) .....4pcs
- ⑧ Nut 螺帽 (M10x1.25-14x9) .....4pcs

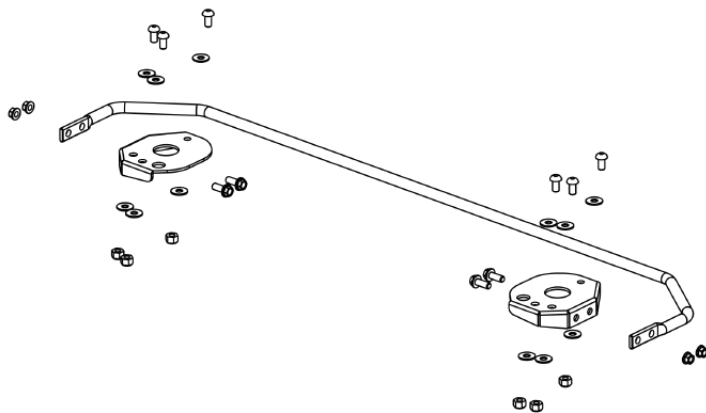

### Caution 注意事項

- Installation is recommended to be performed by licensed mechanics with necessary tools to ensure safety. Incorrect installation may cause injury, damage to the product or vehicle.  
安裝建議由合格的技師及工具執行以確保安全。安裝錯誤可能對人員、產品及車輛造成傷害。
- Note the routing of wires and cables before installation, or please refer to factory manual.  
安裝前請事先記下線路的安裝路徑及位置以維持原廠配置。有疑問時請參考原廠手冊。
- Tighten bolts and nuts firmly by using handtools, and with specified torque if mentioned.  
安裝過程請使用手動工具確實鎖緊螺帽及螺絲。如有特別註明請依照說明指示的扭力上鎖。

### Instructions 安裝說明

1. Drill a hole through the yellow circled lower spring seat hole on the plastic underside cover. (See figure 1)

對準彈簧下座黃色圈起處孔位，於塑膠下護板鑽孔。(參考圖一)

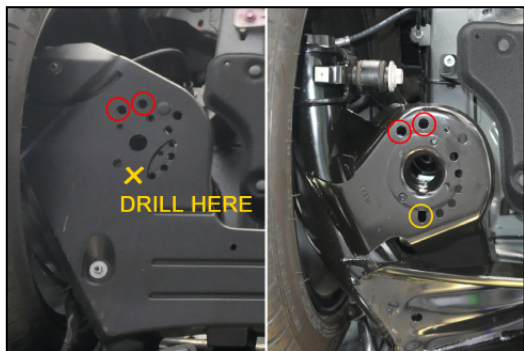

2. Install RH/LH side brackets to the lower spring seat using supplied M10x1.5 bolts, nuts and washers.

使用附件M10x1.5螺絲、螺帽及華司，將左/右側支架安裝至彈簧下座。

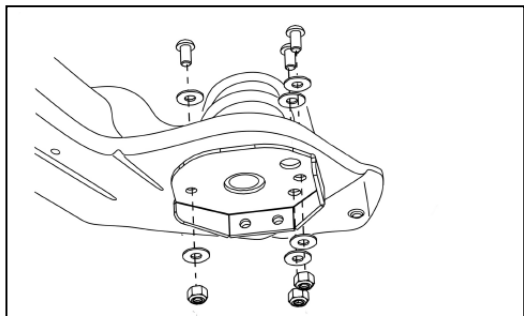

3. Install the sway bar using supplied M10x1.25 bolts and nuts.

使用附件M10x1.25螺絲及螺帽安裝防傾桿。

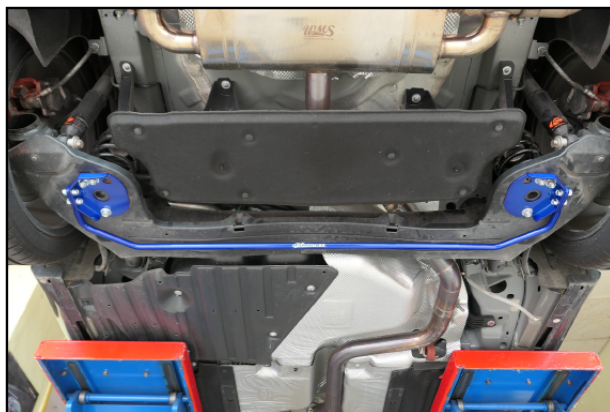
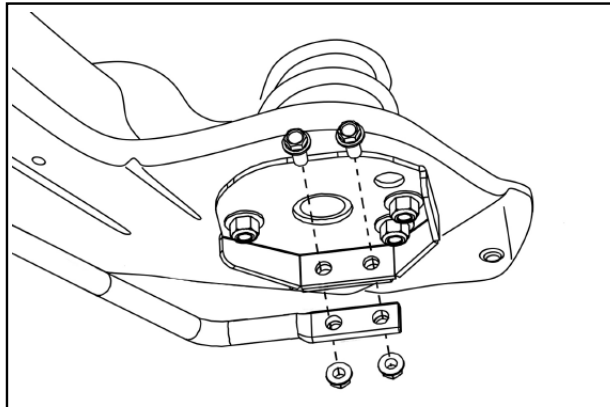

Illustration of installed state  
安裝完成示意圖