

Installation Instructions

安裝說明書

FRONT STRUT BRACE

引擎室拉桿

#Q0403

Application 適用車型

TOYOTA YARIS '05-12 XP90
TOYOTA YARIS / VIOS '13- XP150

Components 內含配件

- ① Brace 結構桿
Cross bar 中間桿.....1pcs
Bracket-RH 支架-右.....1pcs
Bracket-LH 支架-左.....1pcs
Bolt 螺絲 (M10x1.5x75).....2pcs
Nut 螺帽 (M10x1.5-17x10).....2pcs
Washer 華司 (20.8x10.7x2).....4pcs
- ② Bolt 螺絲 (M10x1.25x25).....2pcs
- ③ Nut 螺帽 (M10x1.25-14x9.5).....2pcs
- ④ Washer 華司 (20.8x10.7x2).....4pcs
- ⑤ Bolt 螺絲 (M6x1.0x20).....2pcs
- ⑥ Nut 螺帽 (M6x1.0-10x6).....4pcs
- ⑦ Washer 華司 (18.8x6.4x1.5).....8pcs

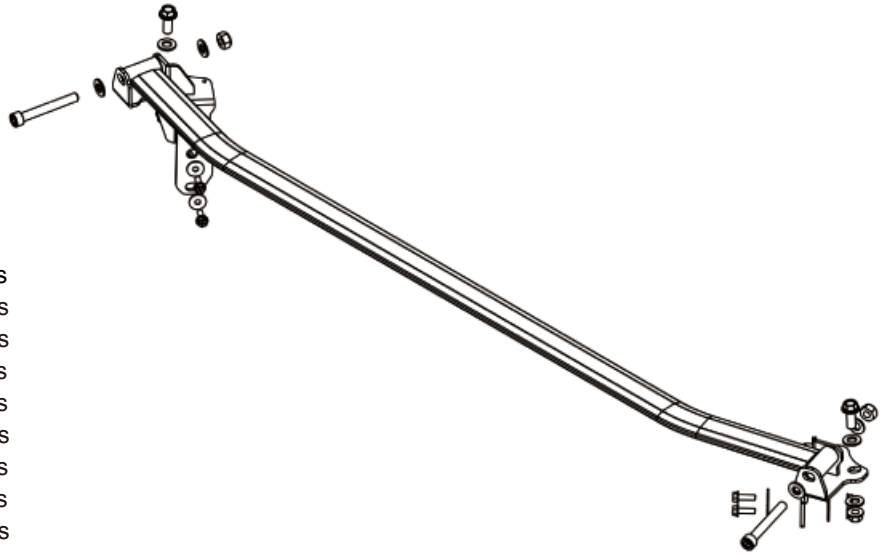

Caution 注意事項

- Installation is recommended to be performed by licensed mechanics with necessary tools to ensure safety. Incorrect installation may cause injury, damage to the product or vehicle. 安裝建議由合格的技師及工具執行以確保安全。安裝錯誤可能對人員、產品及車輛造成傷害。
- Note the routing of wires and cables before installation, or please refer to factory manual. 安裝前請事先記下線路的安裝路徑及位置以維持原廠配置。有疑問時請參考原廠手冊。
- Tighten bolts and nuts firmly by using handtools, and with specified torque if mentioned. 安裝過程請使用手動工具確實鎖緊螺帽及螺絲。如有特別註明請依照說明指示的扭力上鎖。



Instructions 安裝說明

1. Remove the battery and battery tray to get better access to install the LH side bracket.
將電瓶及電瓶固定座拆下，以便安裝左側支架。
2. Remove the two fuse box bracket bolts on LH side strut tower.
拆下位於左側避震塔保險絲盒支架螺絲。
3. Install supplied brackets onto the strut towers on both sides using supplied M10x1.25 and M6x1.0 bolts, nuts and washers.
使用配件M10x1.25及M6x1.0之螺絲、螺帽及華司，將結構桿支架安裝於避震塔上。
4. Reinstall the battery and battery tray.
重新安裝電瓶及電瓶固定座。
5. Install the cross bar using supplied M10x1.5 bolts, nuts and washers.
使用配件M10x1.5螺絲、螺帽及華司安裝中間桿。

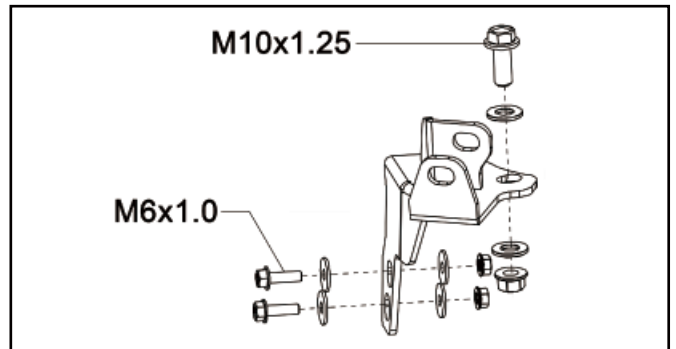

Illustration of installed state 安裝完成示意圖