

Installation Instructions

安裝說明書

FRONT/REAR CASTER ARM
前/後傾角控制臂
#Q0306

Application 適用車型

Porsche Boxster 986 '96-04 (Front only)
Porsche Boxster/Cayman 987 '05-12 (Front only)
Porsche 911 996 '98-04
Porsche 911 997 '05-12

Components 內含配件

① Caster arm 傾角控制臂.....	2pcs
② Spacer 墊片.....	4pcs
③ Bolt 螺絲 (M14x1.5x90).....	2pcs
④ Nut 螺帽 (M14x1.5-21x14).....	2pcs

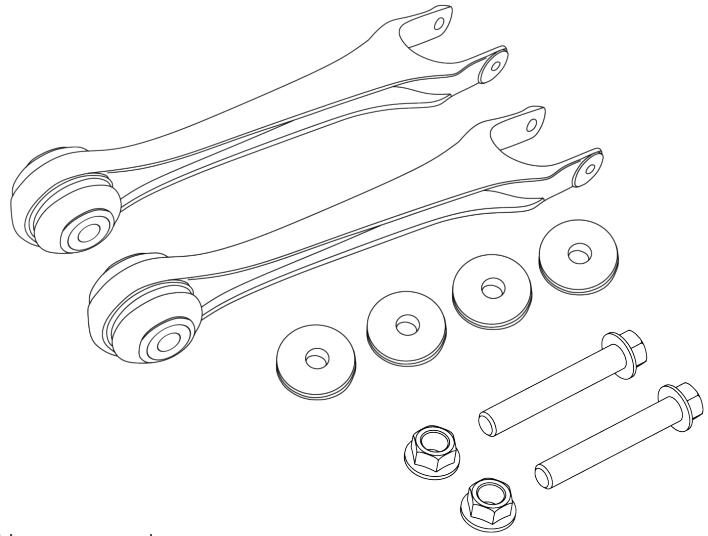

Caution 注意事項

- Installation is recommended to be performed by licensed mechanics with necessary tools to ensure proper installation and safety, or damage to the product or vehicle may occur.
- Note the routing and position of wires and cables before installation. Please refer to factory manual.
- Tighten bolts and nuts firmly using handtools, or with specified torque if mentioned.
- 安裝需由合格的專業技師及工具執行以確保安裝正確及安全。否則可能對產品或車輛造成傷害。
- 安裝前請記下線路安裝路徑及位置。或請參考原廠手冊。
- 請使用手動工具確實鎖緊螺帽及螺絲。或依照說明中標註的扭力上鎖。

Instructions 安裝說明

1. Remove the wheels and plastic undertray to access the control arms.
將車輪卸下，並拆下底盤下護板以便將控制臂拆下。
2. Remove factory lower control arms from chassis, knuckles and caster arms.
將原廠下控制臂從底盤、轉向節以及傾角控制臂卸下。
3. Install Caster arms to the vehicle. Please note the thickness of control arm bushings. Fit supplied spacers if the control arm bushings thickness measure 42mm (See figure)
安裝 控制臂 至車輛。請注意下控制臂鐵套的厚度，若鐵套厚度/高度為42mm，安裝控制臂時請使用配件中的 墊片。(參考圖表)

Note 提示

※ Models with factory 42mm thick bushing control arms
原廠控制臂鐵套厚度/高度為42mm的車型

996 Front/Rear
997 Rear
997 GT2>3 Front/Rear
986 Front

4. Reinstall the plastic undertrays to the vehicle. Please have the vehicle professionally aligned after installation.
將底盤下護板裝回車輛，並於安裝完成後請接受電腦四輪定位校正。

